

# GARDEN SUBURB PUBLIC SCHOOL

*A caring environment providing quality education*

## **Students arriving late and collecting early**

If your child arrives at school after the 9:10am bell, you need to walk them into the office to explain why they are late to school. Please do not drop students off at the front gate and allow them to walk into the office alone.

If you need to collect your child from school early, please call the front office at least ½ hour before you are coming to collect your child so that we can make sure they are at the front office ready for when you arrive. Front office staff will not walk students out to cars, unless there are circumstances requiring this which will be at the front office and Principal's discretion.

## **Progress Place Gate**

To ensure student safety, the hall gate on Progress Place will now be locked each morning at 9:10am. We appreciate your support with this.

## **NAPLAN Information**

Year 3 and Year 5 students will be completing the NAPLAN assessment this term during the testing window which starts on Wednesday 15th March and finishes on Friday 27th March 2023. We will be administering the NAPLAN assessments following the below schedule:

Wednesday 15th March - Writing

Thursday 16th March - Reading

Tuesday 21st March - Language Conventions

Thursday 23rd March - Numeracy

Catch up sessions have been scheduled throughout this week and the following week to cater for student absences.

Year 5 will be completing all assessments online and Year 3 will be completing all assessments online except for writing which remains paper based. School laptops will be used to complete all online assessments as they best support the technical requirements for the NAPLAN portal. We ask for all students to bring a set of headphones to school on Monday 13th March so they can be used during the assessments.

# NAPLAN Information for parents and carers

## 2023

### Why do students do NAPLAN?

NAPLAN is a national literacy and numeracy assessment that students in Years 3, 5, 7 and 9 sit each year. It is the only national assessment all Australian students have the opportunity to undertake.

As students progress through their school years, it's important to check how well they are learning the essential skills of reading, writing and numeracy.

NAPLAN assesses the literacy and numeracy skills that students are learning through the school curriculum and allows parents/carers to see how their child is progressing against national standards and over time.

NAPLAN is just one aspect of a school's assessment and reporting process. It doesn't replace ongoing assessments made by teachers about student performance, but it can provide teachers with additional information about students' educational progress.

NAPLAN also provides schools, education authorities and governments with information about how education programs are working and whether young Australians are achieving important educational outcomes in literacy and numeracy.

### Your child will do the NAPLAN tests online

Schools have transitioned from paper-based to computer-based assessments. All Year 3 students will continue to complete the writing assessment on paper.

Online NAPLAN tests provide more precise results and are more engaging for students. One of the main benefits is tailored (or adaptive) testing, where the test presents questions which may be more or less difficult depending on a student's responses.

Tailored testing allows a wider range of student abilities to be assessed and measures student achievement more precisely. A student's overall NAPLAN result is based on both the number and complexity of questions they answer correctly. Your child should not be concerned if they find questions challenging; they may be taking a more complex test pathway.

### What does NAPLAN assess?

NAPLAN assesses literacy and numeracy skills that students are learning through their regular school curriculum.

Students sit assessments in writing, reading, conventions of language (spelling, grammar and punctuation) and numeracy. The questions assess content linked to the Australian Curriculum: English and Mathematics.

All government and non-government education authorities contribute to the development of NAPLAN test materials.

To find out more about NAPLAN, visit [nap.edu.au](http://nap.edu.au).

### Participation in NAPLAN

NAPLAN is for everyone. ACARA supports inclusive testing so all students have the opportunity to participate in the national assessment program.

Adjustments are available for students with disability who have diverse functional abilities and needs.

Schools should work with parents/carers and students to identify, on a case-by-case basis, reasonable adjustments required for individual students with disability to access NAPLAN. Adjustments should reflect the support normally provided for classroom assessments.

To help inform these decisions, you may consult the [NAPLAN public demonstration site](#), the [Guide for schools to assist students with disability to access NAPLAN](#), or our [series of videos](#) where parents/carers, teachers and students share their experiences in using NAPLAN adjustments.

In exceptional circumstances, a student with a disability that severely limits their capacity to participate in the assessment, or a student who has recently arrived in Australia and has a non-English speaking background, may be granted a formal exemption.

Your school principal and your local test administration authority can give you more information on adjustments for students with disability or the process required to gain a formal exemption.

# ATTENDANCE: WEEK 4



KINDERGARTEN: 98%  
YEAR 1: 88%  
YEAR 2: 89%  
YEAR 3: 93%  
YEAR 4: 93%  
YEAR 5: 98%  
YEAR 6: 98%

PERCENTAGES ARE CALCULATED BASED ON THE YEAR GROUPS' AVERAGE ATTENDANCE RATE



Every day matters



## **Parent Teacher Meetings**

Bookings are now open to book a Parent Teacher meeting with your child's teacher through the Sentral Parent Portal. Parents and carers have until the 28<sup>th</sup> February to book through Sentral. The meetings will take place at the school from the 6<sup>th</sup> March – 24<sup>th</sup> March. Please make sure to make a booking as early as possible to avoid disappointment.

See [link for How To Guide](#) to book a parent teacher meeting through the Sentral Parent Portal. Parents will receive an email notification of the meeting time and date. Please ensure you are prompt for your meeting as teachers have a 15-minute allocation for each booking and meetings will run back-to-back.

If you need assistance making a parent teacher meeting booking, please contact the office.

## **Learning and Support Team (LST)**

Personalised Learning and Support Plan (PLSP) meetings for identified students in K-6 mainstream classes have been scheduled and parents notified. If you have had a PLSP meeting scheduled, please do not book a parent teacher meeting.

## **Expression of Interest for Year 6 transition in Year 7**

Parents of students in Year 6 will receive an Expression of Interest (EOI) link on the 6<sup>th</sup> March 2023 to submit their High School enrolment information. By completing the EOI you indicate which high school(s) you intend on sending your child to for 2024.

This is the first year EOI's can be submitted online via the Garden Suburb Public School website from the 6<sup>th</sup> – 31<sup>st</sup> of March. Information on how to submit this information will be sent with the link. If parents would rather complete the EOI booklet these can be picked up at the office. Booklets will need to be returned to the office by Friday 24<sup>th</sup> March to give enough time to enter this information. We will review and pass on the EOI to your local high school, and if applicable, to your first preference school.

When completing the form, you will be required to provide your child's residential address. The office may contact you if there is any need for follow up.

If your child will not be attending an NSW Government high school in 2024, please notify the school via email. If you are unsure as you are planning to move interstate or enrolling into a private school, we ask that you still complete the EOI and advise GSPS once confirmation of enrolment elsewhere has been received.





# What is curriculum?



The curriculum is a plan for learning based on mandated and approved syllabus documents and current departmental policies and procedures.

The NSW curriculum refers to the suite of resources that are the syllabuses and the support resources to support teachers to implement the syllabuses. This includes, but is not limited to, resources including teaching and learning advice, assessment resources, and syllabus-specific materials including scope and sequences, units of work, standards materials and work samples.

Each year, the students at Garden Suburb Public School will be taught subjects from the following syllabuses developed by the NSW Education Standards Authority:

- **English**
- **Mathematics**
- **Science and Technology**
- **Human Society and Its Environment (HSIE) (History and Geography)**
- **Creative Arts**
- **Personal Development, Health and Physical Education (PDHPE)**

NSW syllabuses provide an outline of the requirements for teaching and learning in various subjects for stages of students' learning. They also contain the outcomes and content which are intended to be inclusive of the learning needs of all students, including:

- **Aboriginal students**
- **students with disability**
- **high potential and gifted education**
- **students learning English as an additional language or dialect (EAL/D).**

Our teaching and learning programs are carefully designed with the needs of your child at the core. Programs are adapted to cater for the needs of each student in the class. Our teachers use a range of high-quality resources to deliver innovative teaching and learning. Evidence-based teaching pedagogies are collaboratively explored and intentionally implemented in classrooms to enhance student learning outcomes and provide engaging learning activities.

At Garden Suburb Public School, we value the important role our parents and carers have in the educational journey of our students. Please contact the school should you have any questions or would like to discuss your child's specific learning needs.



# What is the curriculum reform?



The NSW education system is reforming the curriculum which will be taught in all classrooms from Kindergarten to Year 12. The new curriculum, as a result of the NSW Curriculum Reform, will give students more time to focus on key learning areas so that they can acquire a deeper understanding of central concepts. It will ensure students develop strong foundations for learning, life and work in a complex and fast-changing world.

This reform has been informed by extensive consultation with teachers, parents and education experts, and is underpinned by extensive research. Curriculum reform involves change that spans many aspects of schooling, including teaching, learning, assessment and reporting to parents. New syllabuses provide schools with a unique opportunity to re-focus and place curriculum at the heart of school planning. Key curriculum changes include:

- building strong foundations for future learning with new English and mathematics syllabuses for Kindergarten to Year 2
- an entirely new curriculum from 2022 with new syllabuses focused on what is essential to know and do in early and middle years of schooling, and key learning areas in the senior years
- providing more time for teaching by reducing the hours teachers spend on extra-curricular topics and issues and compliance requirements
- strengthening post-school pathways with new learning areas for Years 11 and 12 that clearly link learning to future employment and study options.

The new curriculum will ensure every student develops strong foundations for learning, life and work. The reforms are vital for the young people in our schools today, and for those who will arrive in the years to come. Please see the attached fact sheet for parents in this newsletter for more information regarding the curriculum reform.

This year, Garden Suburb Public School is implementing the new K-2 English and Mathematics syllabuses in our K-2 classes. Next year we will see our school implementing the new 3-6 English and Mathematics syllabuses.

Staff enthusiastically engaged with extensive professional learning opportunities last year surrounding the evidence-base of the new syllabuses and continue to do so this year. Our careful preparation for the new K-2 syllabuses included liaising with our Cardiff Community of Schools to share best practice, K-2 staff observing schools where the new

syllabuses were being trialled, targeted curriculum planning days, developing explicit instructional teaching sequences and the strategic purchasing of evidence-informed literacy and numeracy resources. Currently, our K-2 classrooms are buzzing with learning as our K-2 teachers and students embark on this exciting educational change together.

In our future newsletters, we will be sharing snippets of our students and teachers engaging with the new curriculum, providing our school community with a 'window of vision' into the exciting initiatives our school undertakes this year.

For more information regarding the curriculum reform, please follow this link:

<https://nswcurriculumreform.nesa.nsw.edu.au/home/siteAreaContent/15b6d3f3-d5f5-4d5d-a99d-80f1541246d0>

## **PSSA Sport**

### **Crossroads Zone Swimming Carnival**

Last Thursday our team of 10 enthusiastic swimmers participated in the Crossroads Zone Swimming Carnival at Speers Point pool. All the swimmers showed superb swimming skills, excellent sportsmanship and were proudly encouraged throughout the carnival by family members. Relays were the final event of the carnival and our 2 relay teams - Junior Girls and Senior Boys – both won their races. What an amazing way to end the day! A special thank you to Mrs Couch for organising our Zone team. Congratulations to Nahní who has moved through to the Hunter Carnival. We wait with anticipation to hear if any other students have been successful.



## Hunter Mountain Bike Competition

Date - 5th April 2023

Registration opens at 8.30am

Cost \$30 per competitor

**Solo Race** – Cross country race around designated track for both Primary and Secondary students. Laps and difficulty of the track will be determined by both age and gender. Places determined on 'first past the post' basis.

**Funduro** – Timed segments of parts of the mountain bike course. These times will be recorded electronically throughout each race division and within allocated time provided after solo races are finished. Best segment times will be added up to determine an overall winner at the end of the day.

### **Mountain Bike Divisions – Primary School**

Gender	Age	Race Description	Expected Time
Male/Female	U7	3 laps of single track course	20-30 mins
Male/Female	U9	3 laps of single track course	20-30 mins
Male Female	U11	2 laps of longer/technical course	25-35 mins
Male/Female	U13	3 laps of longer/technical course	30-40 mins
Male/Female	All Ages	Funduro – Timed segments of mountain bike course	Throughout day

If you have a child/ren interested in entering this competition, please contact the school and a permission note will be sent home. Duty of care and supervision is the responsibility of parents at this event. No supervising teacher will be attending.

Entries must be paid for and returned to the Hunter Sports Association no later than 5pm on 28 March 2023.

### **Zone Representative Teams**

Thank you to those parents and students that have submitted applications for Zone Team trials. To participate in these trials the student must participate at a highly competitive level (e.g. JDL for football (soccer)) or in representative teams.

Mrs Couch has received the applications and is following up with students as further details for the selected sports become available.

Applications for these trials have now closed.



## Coming Up

Check the Sentral Parent Calendar

Add these dates to your calendar

### TERM 1 2023

#### Week 6

Assembly PBL Ambassadors induction (parents welcome) Thurs 2<sup>nd</sup> March 2:25pm – 3pm

Clean Up Australia Day Sat 4<sup>th</sup> March

#### Week 7

P&C Meeting Mon 6<sup>th</sup> March

EOI link open Yr 6 into Yr 7 Mon 6<sup>th</sup> March

Parent Teacher Interviews Mon 6<sup>th</sup> March – Fri 24<sup>th</sup> March

National Ride to School Day Fri 24<sup>th</sup> March

#### Week 8

NAPLAN Yr 3 & 5 Writing Wed 15<sup>th</sup> March

NAPLAN Yr 3 & 5 Reading Thurs 16<sup>th</sup> March

Assembly (Parents welcome) Thurs 16<sup>th</sup> March

Assembly (Parents welcome) Thurs 16<sup>th</sup> March

#### Week 9

NAPLAN Yr 3 & 5 Language Conventions Tues 21<sup>st</sup> March

NAPLAN Yr 3 & 5 Numeracy Thurs 23<sup>rd</sup> March

#### Week 10

Cross Country Carnival Tues 28<sup>th</sup> March

#### Week 11

School Photo Day Tues 4<sup>th</sup> April

# WHAT'S HAPPENING

## PBL Ambassadors

Our PBL Ambassadors will be inducted at the Week 6 assembly. The students are selected by their peers and give students a voice in our school. These students must adhere to the roles and responsibilities of a PBL Ambassador. They will meet every fortnight with the coordinating teachers to discuss ideas and concerns, offer suggestions, plan events and create lessons.

## Book Club

We kindly ask that all orders for Book Club be made through LOOP. Book Club's online ordering platform. There are extra copies in the office if needed.

SCHOLASTIC  
**Book Club LOOP**  
for Parents

LOOP is the Scholastic Book Club  
Linked Online Ordering & Payment platform for parents.  
To order and pay for Scholastic Book Club by credit card visit:  
[www.scholastic.com.au/LOOP](http://www.scholastic.com.au/LOOP)

GET IT ON  
Google play

Download on the  
App Store

## School Photos

On Tuesday 4<sup>th</sup> April students will have their school photo taken. Please make sure students are dressed in full school uniform.

To view packages and order online go to [www.newcastleschoolportraits.com](http://www.newcastleschoolportraits.com)

The GSPS Shoot Code is: 310594

Orders to be placed before photo day to avoid a late fee.

If you would prefer to pay cash envelopes will be sent home shortly.



## PBL Paddlepops

Congratulations to all the winners, who were lucky enough to receive a PBL Paddlepop or iceblock this fortnight.





# ENVIRONMENTAL NEWS

## Week 5, 2023

Friday 3rd March is Clean Up Australia Day at school. Students will be cleaning up designated areas within the school grounds with their class teacher. Buckets and tongs will be provided. If your child would like to bring gloves from home they can, preferably reusable garden gloves.

Although we had a very wet Wednesday, the gardens would have been having a refreshing drink after such hot days.

Our students have been creative in our gardens, lots of imaginative play.



Julie Brewer





**TOTALLY TRASH FREE TUESDAY**

On Tuesdays, students and staff are encouraged to bring their lunch, recess and fruit to school in a reusable container, and bring a refillable water bottle. Rubbish bins will be removed from the playground, and students will take home any food packaging.

**HELP GSPS BE TOTALLY TRASH FREE ON TUESDAYS!**



## Uniform Shop

Uniforms can be purchased through the QuickCliq system, or by returning a form to the school with cash or direct deposit details. Uniforms will be sent home with the selected student unless otherwise advised in the order.

Back to School vouchers are able to be used at the Uniform Shop. Please follow the instructions on the following pages.

We have a vacancy for a Volunteer Uniform Shop co-ordinator. Please enquire at the office if you are interested.



GARDEN SUBURB PUBLIC SCHOOL P&C UNIFORM SHOP

## DID YOU KNOW ?



## The Uniform Shop sells...

Available Thursdays at School, on Quickcliq or enquire at the School Office  
 PLUS CHECKOUT THE SECOND HAND OPTIONS - MOST ITEMS AVAILABLE FOR \$2!  
 Just a reminder our uniform includes Black Shoes and White Socks

## Canteen

The cut-off time to place orders through Quickcliq is 9am. Please ensure orders are placed well before this time as the system can be overloaded at this time.

Canteen Volunteers	
Friday 24 <sup>th</sup> February	Simone, Alison & Stephanie
Wednesday 1 <sup>st</sup> March	Minyon & Danielle
Thursday 2 <sup>nd</sup> March	Karen
Friday 3 <sup>rd</sup> March	Jenny & Sarah

Volunteers are needed for the canteen. Please contact the office if you have a spare hour or two on Wednesday, Thursday or Friday mornings.

## Register for QuickCliq – Garden Suburb Public School Canteen & School Uniform Online Ordering

### Summary

Use this quick reference guide to:

- Create an account
- Add your child/s details to the account
- Add credit to the account to make purchases

### Instructions – Create an account

On your computer or mobile phone go to website [www.quickcliq.com.au](http://www.quickcliq.com.au) and click on the 3 lines (hamburger) in the top right-hand corner.

Select **'Register'** from the list

Fill out all details under **'Sign Up'** and select **'Finish'**.

Use a valid email address as QuickCliq will send you a verification email and you will need to click on the link to verify your account. Check your email. Please note it may have gone to your junk or spam folder.

Click on the **'Activate your user account'** link in the email.

**SIGN UP A NEW USER ACCOUNT**

Please fill out the form below to register your account with QuickCliq. You will then receive a verification email to activate your account.

If you have an existing account and cannot log in contact QuickCliq before signing up again.

30/10/2022

Email

Confirm Email

Password

**Note:** Your chosen password needs to have a mix (min) of 8 characters including one number, one uppercase letter, one lower case letter and one special character. For example: **Can@32r!**

support@quickcliq.com.au 9:18 pm  
To: Jennifer Guest

**Welcome to QuickCliq**

Dear Jennifer Guest:

Welcome to QuickCliq, an easy and more convenient way to order from your school's canteen, uniform shop and much more. We hope you will find it to be a great asset.

Thank you for registering. To ensure you can log in to our system, please validate your email address by following the link below.

Click Below to:

>> [Activate your user account](#) <<

**QuickCliq** Kind Regards  
QuickCliq  
Phone: 1300 11 96 37  
Website: [www.quickcliq.com.au](http://www.quickcliq.com.au)  
Email: [support@quickcliq.com.au](mailto:support@quickcliq.com.au)

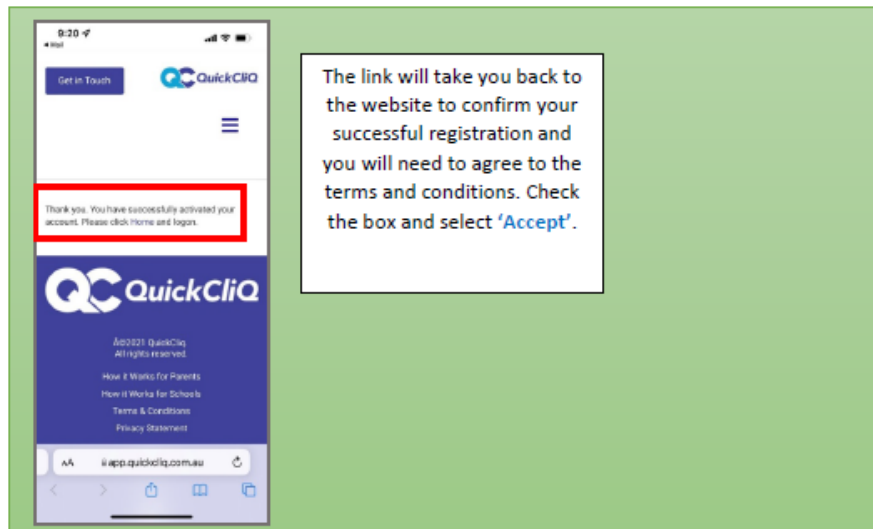

**Instructions – Adding your child/s details to the account**

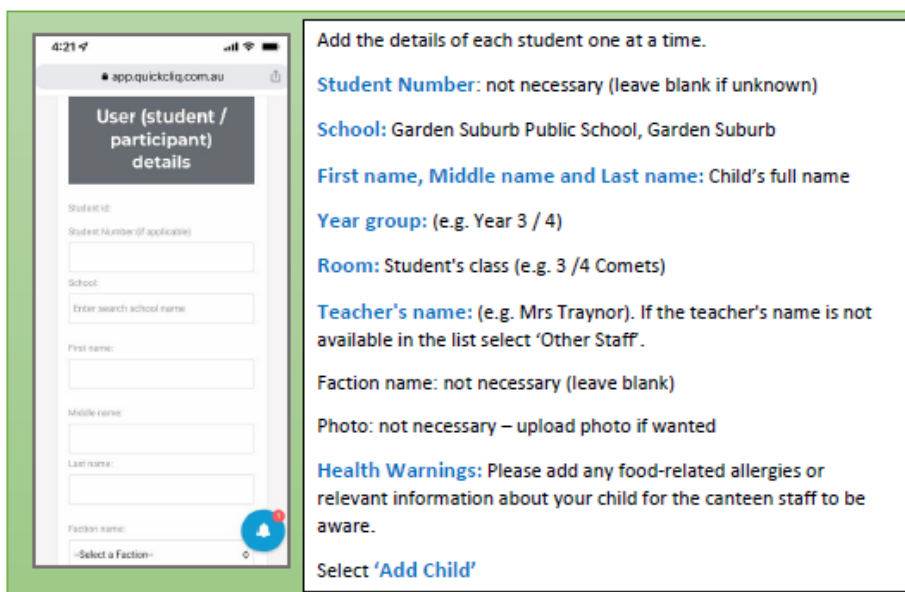
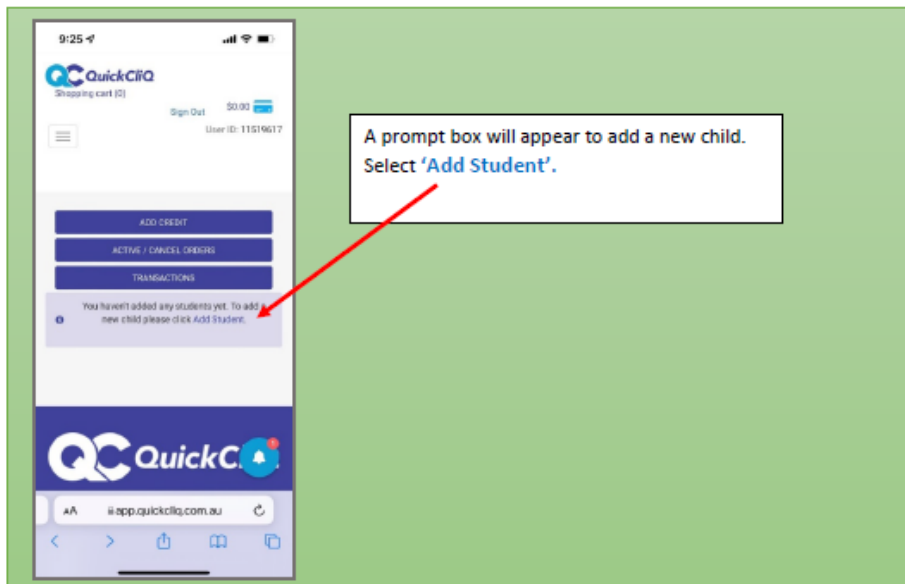



# How to claim for Uniform Purchases

## Orders Placed via QuickCliq

QuickCliq has not been able to implement on-the-spot processing of vouchers at the time of your order placement.

Orders placed via QuickCliq need to be paid in full, and voucher(s) sent to P&C email with your bank details.

Upon successful processing of the voucher, a refund will be made directly to your nominated bank account.

Please note that refunds will be processed when your order is completed (each Friday)

*If the voucher fails to process, then a refund will not be made.*

Place order in QuickCliq  
**PAY IN FULL**



Email your Back to School Voucher to the P&C Email address with your bank details



Refund to be settled when the uniform order is completed



## Orders placed via Uniform Form

For orders placed via the Uniform Form and paid via any payment method other than QuickCliq, please pay the difference between your order total and the voucher(s) value.

Uniform orders via the Uniform Form (and placed in the P&C box at the office) will be processed each Friday when the Uniform Shop is open.

Voucher(s) can be presented in-store (Friday's 9am) or via P&C email for processing.

*If the voucher fails to process, the balance of the order will need to be repaid to the Uniform Shop.*

Complete Uniform Order Form and place in P&C Box in office



Complete payment via cash, direct deposit to bank, cheque or Square terminal in-store  
**PAY THE DIFFERENCE**



Present voucher in-store or via P&C email for processing

### *Please note for all payment methods:*

If the uniform order value is less than the total voucher value you intend to claim, only the order value will be refunded or claimed, and the difference of your voucher will be forfeited.

★ **All valid vouchers can be used until 30 June 2023!** ★



P&C Email:

[gardensuburbpublicschool@pandcaffiliate.org.au](mailto:gardensuburbpublicschool@pandcaffiliate.org.au)

# COMMUNICATION

Please use the following forms of communication with the school to stay up to date

## Sentral Parent Portal App

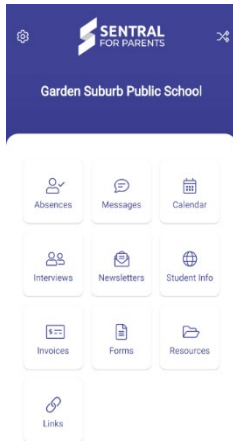

The school uses the Sentral Parent Portal app to communicate all school updates, newsletters, permission notes and fundraising opportunities with our parent community. Parents can also submit absence requests, check the school calendar for upcoming events and message the class teacher.

All new parents and carers to the school should have received a welcome email with instructions on how to register and your access key. If you don't have an access key, please let the office know. Parents can have multiple access keys for each parent to stay up to date on what's happening in the school.

## QuickCliq

Canteen and Uniforms orders can be purchased online through the website QuickCliq. Parents are encouraged to register an account, add their students details to the account and purchase credit through the website. For detailed instructions please see ['How to'](#) guide.



## Website

Information regarding the school's policies, planning, reporting, expectations, P&C and so much more can be found on our [website](#). All parent payments and enrolment applications are made online using the quick link tabs along the top of the home page.

## Facebook



The school has a Facebook page where you can find information on student successes, good news stories and community information. Our school Facebook page can be found by searching 'Garden Suburb Public School' on Facebook.

## NSW School Updates app

The NSW School Updates App has the ability for parents and carers with children in multiple schools to receive newsletters and updates within the same app and receive push notifications on their phones when newsletters and events are posted by the school. Information feeds are filtered by school year are customised for parents and carers and includes direct contact line details to the school.